

# M23 SIGNAL CONNECTORS

## HOUSINGS

### M23 Signal Right Angle Connector, Female Thread, Positioning

#### Cable-Ø

#### Part Number

3 - 7 mm (.12 - .28")	S7.300.300.000
5 - 10 mm (.20 - .39")	S7.300.400.000
7 - 12 mm (.28 - .47")	S7.300.500.000
10 - 14 mm (.39 - .55")	S7.300.600.000

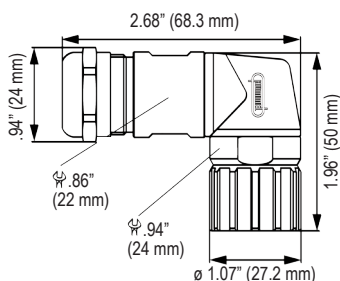

### M23 Signal Right Angle Connector, Female Thread, EMI, Positioning

#### Cable-Ø

#### Part Number

7 - 12 mm (.28 - .47")	S7.301.500.000
10 - 14 mm (.39 - .55")	S7.301.600.000

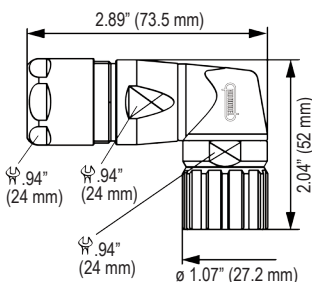

### M23 Signal Right Angle Connector, EMI, Rotatable

#### Cable-Ø

#### Part Number

7 - 12 mm (.28 - .47")	S7.306.500.000
11 - 17 mm (.43 - .67")	S7.306.600.000

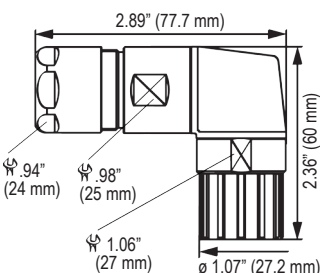

### M23 Signal Panel Connector, Male Thread, Flange

#### Type

#### Part Number

<b>Front Mounting, Flange 25 x 25 mm</b>	
4 x Holes Ø 3.2 mm	☒ S7.400.000.000
4 x Threaded M3	☒ S7.402.000.000
Optional: Flat gasket....STAD2-7P2510	
4 x Holes Ø 2.7 mm	☒ S7.404.000.000
4 x Threaded M2.5	☒ S7.406.000.000
Optional: Flat Gasket....STAD1-7P2510	

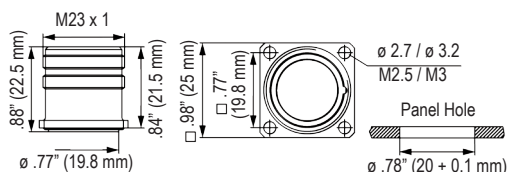

### M23 Signal Panel Connector, Male Thread, Flange Standard Threaded and TWILOCK/TWILOCK-S\* - Quick Connect

#### Type

#### Part Number

<b>Front Mounting, Flange 25 x 25 mm</b>	
4 x Holes Ø 3.2 mm	☒ S7.410.000.000
4 x Threaded M3	☒ S7.412.000.000
Optional: Flat Gasket....STAD2-7P2510	
4 x Holes Ø 2.7 mm	☒ S7.414.000.000
4 x Threaded M2.5	☒ S7.416.000.000
Optional: Flat Gasket....STAD1-7P2510	

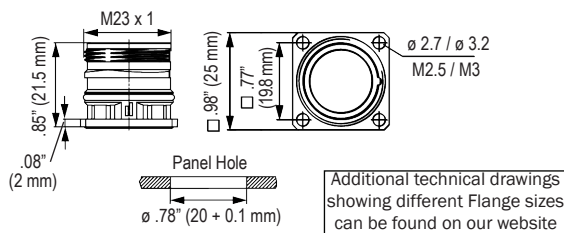

Additional technical drawings showing different Flange sizes can be found on our website

<b>*Intermateable with SpeedTEC® (Twilock-S)</b>	
4 x Holes 3.2 mm, Flange 25 x 25 mm	☒ S7.410.000.00S
Optional: Flat Gasket....STAD2-7P2510	
4 x Holes 3.2 mm, Flange 28 x 28 mm	☒ S7.410.100.00S

☒ MATES WITH TWILOCK SYSTEM

☒ DOES NOT MATE WITH TWILOCK SYSTEM