

Power Series Puissance — circular 95 mm² single-pole connectors 300 A

Technical Data

RoHS

Panel connector, cable connector
and coupler connector

Locking	circular housing
Protection	screw connection
Contacts	IP 50 to IP 54 with conexit in the housing and flat-gasket for panel connector (delivered with the panel connector)
Max. current	1 removable crimp contact ø 12 mm
Contact resistance between pin and socket	300 A
Insulation resistance	< 0,02 mΩ ø 12 mm
Breakdown voltage between contact and housing	> 10000 Volts (RMS)
Mechanical endurance	> 3000 Volts (RMS)
Operating temperature	10000 locking and mating cycles
Salt spray resistance	-40 °C to +100 °C (120 hours at +120 °C)
Materials	240 hours
Max. cross-section of crimped conductors	Light alloy, black anodising, silver-plated brass contacts, polyoxymethylene (POM) insert
	95 mm ² cross-section: crimp directly
	70 mm ² cross-section: install a reducer

Panel connector



Cable connector



Dimensional Data

Panel connector

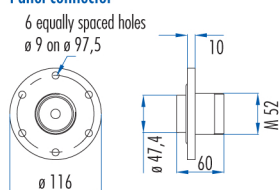

Cable connector

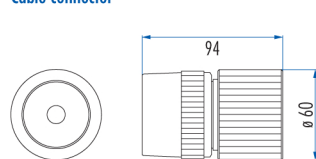

Coupler connector

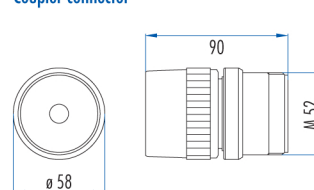

Bulkhead connector

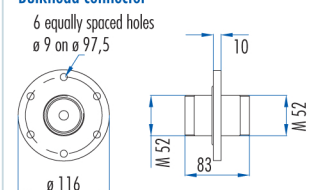

Power Series Puissance — circular 95 mm² single-pole connectors 300 A

Part Number

Housing	5
Number of Contacts ø 12 mm	1

Male panel connectors — Female cable connectors — Male coupler connectors

Circular male panel connector	895 311 206
Female cable connector	895 221 006
Male coupler connector	895 111 006
Cable clamps	D or E see below
Flat-Gasket for panel connector (pack of 10)	round 536 136 006
Protective cap for panel connector	809 306 006
Protective cap for cable connector	809 406 006

Crimp tool: 809 875 006 with crimp jaws 809 912 006 for ø 12 mm

Tool for insertion and removing contacts 896 903 006

Female panel connectors — Male cable connectors — Female coupler connectors

Circular female panel connector	895 321 206
Male cable connector	895 211 006
Female coupler connector	895 121 006
Cable clamps	D or E see below
Flat-Gasket for panel connector (pack of 10)	round 536 136 006
Protective cap for panel connector	809 306 006
Protective cap for cable connector	809 406 006
Male / female bulkhead connector	895 301 206

Crimp tool: 809 875 006 with crimp jaws 809 912 006 for ø 12 mm

Tool for insertion and removing contacts 896 903 006

Part numbers and dimensions of cable clamps:

Circular housing

- D: 809 605 006: ø 20 to ø 32 mm

- E: 809 625 006: ø 20 to ø 25 mm

- Panel connectors are delivered with their O-ring.

- For 95 mm² contacts, if a cable with a smaller cross-section is used, a reducer, delivered with the cable connector, must be used.

- **Important:** The contact must be mounted in the insert using our tool.

- For assembly, wiring, panel connector installation and contact arrangement instructions, see: Technical guides;

- Other accessories, see: Accessories.

- All connectors are delivered with their contact.

Technical Data

RoHS

Panel connector, cable connector
and coupler connector

Locking	screw connection
Protection	IP 50, IP 54 with conexil in the housing and flat-gasket for panel connector (delivered with the panel connector)
Contacts	1 removable crimp contact ø 8 mm
Max. current	175 A
Contact resistance between pin and socket	< 0,03 mΩ ø 8 mm
Insulation resistance	> 10000 MΩ
Breakdown voltage between contact and housing	> 3000 Volts (RMS)
Mechanical endurance	10000 locking and mating cycles
Operating temperature	-40 °C to +100 °C (120 hours at +120 °C)
Salt spray resistance	240 hours
Materials	Light alloy, black anodising, silver-plated brass contacts, polyoxymethylene (POM) insert
Max. cross-section of crimped conductors	35 mm ² cross-section: crimp directly

Panel connector



Cable connector



rectangular housing

Dimensional Data

Panel connector

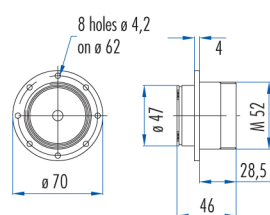

Cable connector

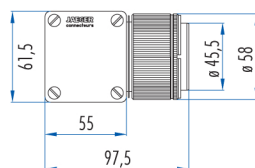

Power Series Puissance – rectangular single-pole 35 mm² connectors 175 A

Part Number

Housing	5
Number of Contacts ø 8 mm	1
Female panel connectors – Male cable connectors – Female coupler connectors	
Circular female panel connector	801 141 356
Male cable connector	802 201 356
Cable clamps	A or B or C see below
Flat-Gasket for panel connector (pack of 10)	round 536 136 006
Protective cap for panel connector	809 306 006
Protective cap for cable connector	809 406 006

Crimp tool: 809 835 006 with crimp jaws 809 909 006 for ø 8 mm

Tool for insertion and removing contacts 806 903 006

Part numbers and dimensions of cable clamps:

Rectangular housing

- A: 839 603 006: ø 15 to ø 20 mm
- B: 839 604 006: ø 15 to ø 23 mm
- C: 839 605 006: ø 15 to ø 28 mm

- The panel connector is delivered with a flat-gasket for the panel connector, 4 screws, 4 washers and 4 nuts.
- For 35 mm² contacts, we recommend a class 6 extra-flexible cable. If you wish to use a class 5 flexible cable, a reducer must be added.
- **Important:** The contact must be mounted in the insert using our tool.
- For assembly, wiring, panel connector installation and contact arrangement instructions, see: Technical guides;
- Other accessories, see: Accessories.
- All connectors are delivered with their contact.

Technical Data

RoHS

Panel connector, cable connector
and coupler connector

Locking

Protection

Contacts

Max. current

Contact resistance between pin and socket

Insulation resistance

Breakdown voltage between contact and housing

Mechanical endurance

Operating temperature

Salt spray resistance

Materials

Max. cross-section of crimped conductors

Connection safety

Panel connector



circular housing

screw connection

IP 65 with flat-gasket for panel connector

3 contacts ø 8 mm (2 phases + ground) and 2 removable crimp pilot contacts ø 1,6 mm

175 A

< 0,03 mΩ ø 8 mm

> 10000 MΩ

> 3000 Volts (RMS)

10000 locking and mating cycles

-40 °C to +100 °C (120 hours at +120 °C)

240 hours

Light alloy, black anodising, silver-plated brass contacts ø 8 mm,
gold-plated brass contacts ø 1,6 mm, polyoxymethylene (POM) insert

35 mm² cross-section: crimp directly

2 pilot contacts ø 1,6 mm

Cable connector



Dimensional Data

Square panel connector

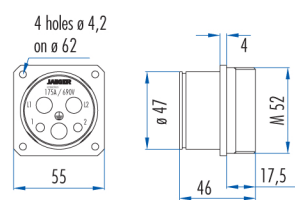

Circular panel connector

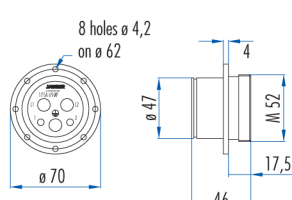

Cable connector

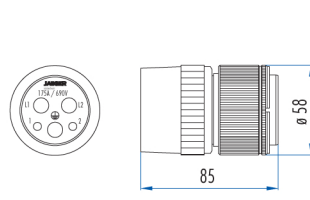

Coupler connector

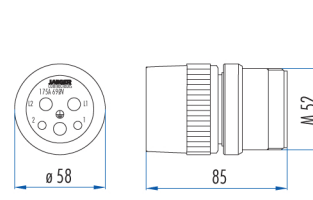

Power Series Puissance – circular multi-pole 35 mm² connectors 175 A

Part Number

Housing	5
Number of Contacts	5
L ø 8 mm	3
L ø 1,6 mm	2

Male panel connectors – Female cable connectors – Male coupler connectors

Circular male panel connector	801 105 356
Square male panel connector	801 115 356
Female cable connector	832 203 356
Male coupler connector	833 103 356
Cable clamps	D or E see below
Flat-Gasket for panel connector (pack of 10)	round 536 136 006 square 536 136 016
Protective cap for panel connector	809 306 006
Protective cap for cable connector	809 406 006

Crimp tool: 809 835 006 with crimp jaws 809 909 006 for ø 8 mm, 579 481 006 crimp tool with positioner for ø 1,6 mm

Tool for insertion and removing contacts 806 903 006

Female panel connectors – Male cable connectors – Female coupler connectors

Circular female panel connector	801 205 356
Square female panel connector	801 125 356
Male cable connector	832 103 356
Female coupler connector	833 203 356
Cable clamps	D or E see below
Flat-Gasket for panel connector (pack of 10)	round 536 136 006 square 536 136 016
Protective cap for panel connector	809 306 006
Protective cap for cable connector	809 406 006

Crimp tool: 809 835 006 with crimp jaws 809 909 006 for ø 8 mm, 579 481 006 crimp tool with positioner for ø 1,6 mm

Tool for insertion and removing contacts 806 903 006

Part numbers and dimensions of cable clamps:

Circular housing

- D: 809 605 006: ø 20 to ø 32 mm

- E: 809 625 006: ø 20 to ø 25 mm

- The panel connector is delivered with a flat-gasket for the panel connector, 4 screws, 4 washers and 4 nuts.
- For 35 mm² contacts, we recommend a class 6 extra-flexible cable. If you wish to use a class 5 flexible cable, a reducer must be added.
- **Important:** All the contacts must be mounted in the insert using our tool.
- For assembly, wiring, panel connector installation and contact arrangement instructions, see: Technical guides;
- Other accessories, see: Accessories.
- All connectors are delivered with their contacts.

Power Series Puissance — circular and rectangular multi-pole 25 mm² connectors 175 A

Technical Data

RoHS

Panel connector, cable connector and coupler connector

Locking

Protection

Contacts

Max. current

Contact resistance between pin and socket

Insulation resistance

Breakdown voltage between contact and housing

Mechanical endurance

Operating temperature

Salt spray resistance

Materials

Max. cross-section of crimped conductors

Connection safety

Panel connector



Rectangular cable connector



Circular cable connector



circular housing

screw connection

Depending on the associated cable connector

IP 65 with flat-gasket for panel connector

IP 50 – 54 with conexil in the housing
gasket for panel connector

3 contacts ø 8 mm (2 phases + ground) and 2 removable

175 A

< 0,03 mΩ ø 8 mm

> 10000 MΩ

> 3000 Volts (RMS)

10000 locking and mating cycles

-40 °C to +100 °C (120 hours at +120 °C)

240 hours

Light alloy, black anodising, silver-plated brass contacts ø 8 mm,
gold-plated brass contacts ø 16 mm, polyoxymethylene (POM) insert

25 mm² cross-section: crimp directly

16 mm² cross-section: install a reducer

2 pilot contacts ø 1,6 mm



Dimensional Data

Circular cable connector

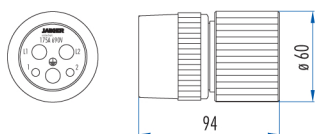

Rectangular cable connector

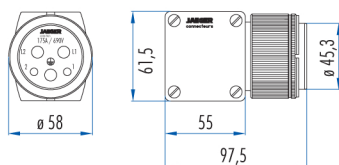

Circular panel connector

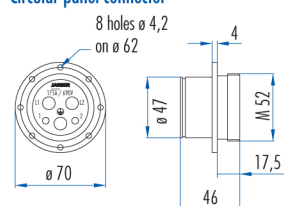

Square rectangular panel connector

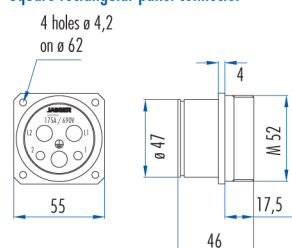

Circular coupler connector

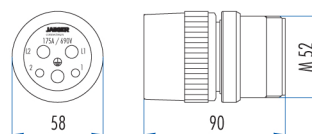

Circular panel connector

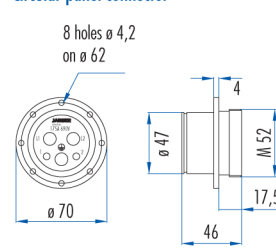

Rectangular coupler connector

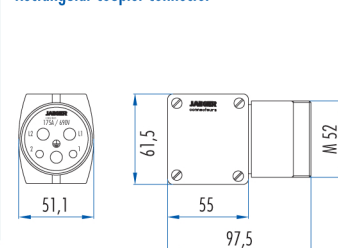

Power Series Puissance – circular and rectangular multi-pole 25 mm² connectors 175 A

Part Number

Housing	5	5
Number of Contacts	5	5
L ø 8 mm	3	3
L ø 1,6 mm	2	2

Male panel connectors – Female cable connectors – Male coupler connectors

	rectangular IP 65	circular IP 50 – 54
Circular male panel connector	801 205 006	801 145 006
Square male panel connector	801 125 006	
Female cable connector	832 105 006	802 203 006
Male coupler connector	833 205 006	803 103 006
Cable clamps	A or B or C see below	D or E see below
Flat-Gasket for panel connector (pack of 10)	round 536 136 006 square 536 136 016	536 136 006
Protective cap for panel connector	809 306 006	809 306 006
Protective cap for cable connector	809 406 006	809 406 006

Crimp tool: 809 835 006 with crimp jaws 809 908 006 for ø 8 mm, 579 481 006 crimp tool with positioner for ø 1,6 mm

Tool for insertion and removing contacts 806 903 006

Female panel connectors – Male cable connectors – Female coupler connectors

	rectangular IP 65	circular IP 50 – 54
Circular female panel connector	801 105 006	801 245 006
Square female panel connector	801 115 006	
Male cable connector	832 205 006	802 103 006
Female coupler connector	833 105 006	803 203 006
Cable clamps	A or B or C see below	D or E see below
Flat-Gasket for panel connector (pack of 10)	round 536 136 006 square 536 136 016	536 136 006
Protective cap for panel connector	809 306 006	809 306 006
Protective cap for cable connector	809 406 006	809 406 006

Crimp tool: 809 835 006 with crimp jaws 809 908 006 for ø 8 mm, 579 481 006 crimp tool with positioner for ø 1,6 mm

Tool for insertion and removing contacts 806 903 006

Part numbers and dimensions of cable clamps:

Rectangular housing	Circular housing
- A: 839 603 006: ø 15 to ø 20 mm	- D: 809 605 006: ø 20 to ø 32 mm
- B: 839 603 006: ø 15 to ø 23 mm	- D: 809 625 006: ø 20 to ø 25 mm
- C: 839 605 006: ø 15 to ø 28 mm	

- The panel connector is delivered with a flat-gasket for the panel connector, 4 screws, 4 washers and 4 nuts.
- For 35 mm² contacts, we recommend a class 6 extra-flexible cable. If you wish to use a class 5 flexible cable, a reducer must be added.
- **Important:** All the contacts must be mounted in the insert using our tool.
- For assembly, wiring, panel connector installation and contact arrangement instructions, see: Technical guides;
- Other accessories, see: Accessories.
- All connectors are delivered with their contacts.

Technical Data

RoHS

Panel connector, cable connector
and coupler connector

Locking	circular housing
Protection	screw connection
Contacts	IP 50, IP 54 with conexil in the housing and flat-gasket for panel connector (delivered with the panel connector)
Max. current	4 contacts de ø 8 mm
Contact resistance between pin and socket	175 A
Insulation resistance	< 0,03 mΩ ø 8 mm
Breakdown voltage between contact and housing	> 10000 MΩ
Mechanical endurance	> 3000 Volts (RMS)
Operating temperature	10000 locking and mating cycles
Salt spray resistance	-40 °C to +100 °C (120 hours at +120 °C)
Materials	240 hours
Max. cross-section of crimped conductors	Light alloy, black anodising, silver-plated brass contacts, polyoxymethylene (POM) insert
	25 mm² cross-section: crimp directly
	16 mm² cross-section: install a reducer

Panel connector



Cable connector



Dimensional Data

Panel connector

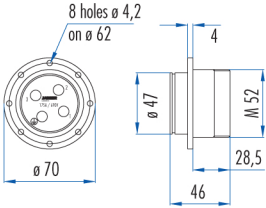

Cable connector

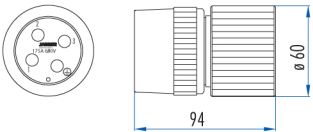

Coupler connector

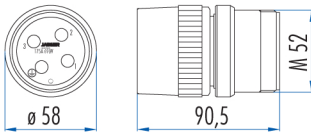

Power Series Puissance – circular multi-pole 25 mm² connectors 175 A

Part Number

Housing	5
Number of Contacts ø 8 mm	4

Male panel connectors – Female cable connectors – Male coupler connectors

Circular male panel connector		841 145 006
Female cable connector		842 203 006
Male coupler connector		843 103 006
Cable clamps		D or E see below
Flat-Gasket for panel connector (pack of 10)	round	536 136 006
Protective cap for panel connector		809 306 006
Protective cap for cable connector		809 406 006

Crimp tool: 809 835 006 with crimp jaws 809 908 006

Tool for insertion and removing contacts 806 903 006

Female panel connectors – Male cable connectors – Female coupler connectors

Circular female panel connector		841 245 006
Male cable connector		842 103 006
Female coupler connector		843 203 006
Cable clamps		D or E see below
Flat-Gasket for panel connector (pack of 10)	round	536 136 006
Protective cap for panel connector		809 306 006
Protective cap for cable connector		809 406 006

Crimp tool: 809 835 006 with crimp jaws 809 908 006

Tool for insertion and removing contacts 806 903 006

Part numbers and dimensions of cable clamps:

Circular housing

- D: 809 605 006: ø 20 to ø 32 mm

- E: 809 625 006: ø 20 to ø 25 mm

- The panel connector is delivered with a flat-gasket for the panel connector, 4 screws, 4 washers and 4 nuts.

- For 25 mm² contacts, if a cable with a smaller cross-section is used, a reducer must be used.

- **Important:** All the contacts must be mounted in the insert using our tool.

- For assembly, wiring, panel connector installation and contact arrangement instructions, see: Technical guides;

- Other accessories, see: Accessories.

- All connectors are delivered with their contacts.