





Conformity	
Certificates and Approvals:    	
Technical information	
UL File no:	E189312
UL category:	NITW, NITW7
Environmental type (UL):	4X, 12, 13, 6P
Outdoor suitability:	UL 746C (f1) rated material
Operating temperature:	-40°F... +176°F (-40°C... +80°C)
Short term temperature range:	-40°F... +248°F (-40°C... +120°C)
Flammability rating:	UL 746C
Impact resistance:	IK10 (-31°F...104°F / -35°C...+40°C)
Insulation:	Class II

POLYCON SERIES

SIZE: 9X7X5 TO 19X17X11 INCHES

Features and Benefits

- Industry exclusive corner elevator system
- Light and tough - excellent impact and flame resistance
- Made of rugged industrial polycarbonate material
- High level of technical features and approval ratings
- Meets NEMA 6P & IP69 protection ratings
- Multiple modification possibilities

Available Accessories

- Back Panels
- Hinged Front Kits
- Full Front Cover
- Ventilation Devices



Polycon Series Polycarbonate Enclosures

Part Number	Length Inch (mm)	Width Inch (mm)	Depth Inch (mm)	IP 66	IP 68	IP 69	Hinged Cover	Screw Cover	Opaque Cover	Clear Cover	Mounting Flange	Metal Locking Latch	Non-Metal Locking Latch
SUPCG040608	8.78 (223)	6.77 (172)	5.27 (134)	•	•	•		•	•				
SUPCT040608	8.78 (223)	6.77 (172)	5.27 (134)	•	•	•		•		•			
SUPCG040608F	8.78 (223)	6.77 (172)	5.27 (134)	•	•	•		•	•		•		
SUPCT040608F	8.78 (223)	6.77 (172)	5.27 (134)	•	•	•		•		•	•		
SUPCG040608HML	8.78 (223)	6.77 (172)	5.27 (134)	•	•	•	•	•	•			•	
SUPCT040608HML	8.78 (223)	6.77 (172)	5.27 (134)	•	•	•	•	•		•		•	
SUPCG040608HMLF	8.78 (223)	6.77 (172)	5.27 (134)	•	•	•	•	•	•		•	•	
SUPCT040608HMLF	8.78 (223)	6.77 (172)	5.27 (134)	•	•	•	•	•		•	•	•	
SUPCG040608HNL	8.78 (223)	6.77 (172)	5.27 (134)	•	•	•	•	•	•				•
SUPCT040608HNL	8.78 (223)	6.77 (172)	5.27 (134)	•	•	•	•	•		•			•
SUPCG040608HNLF	8.78 (223)	6.77 (172)	5.27 (134)	•	•	•	•	•	•		•		•
SUPCT040608HNLF	8.78 (223)	6.77 (172)	5.27 (134)	•	•	•	•	•		•	•		•
SUPCG040608HS	8.78 (223)	6.77 (172)	5.27 (134)	•	•	•	•	•	•				
SUPCT040608HS	8.78 (223)	6.77 (172)	5.27 (134)	•	•	•	•	•		•			
SUPCG040608HSF	8.78 (223)	6.77 (172)	5.27 (134)	•	•	•	•	•	•		•		
SUPCT040608HSF	8.78 (223)	6.77 (172)	5.27 (134)	•	•	•	•	•		•	•		
SUPCG060810	10.85 (276)	8.85 (225)	7.27 (185)	•	•	•		•	•				
SUPCT060810	10.85 (276)	8.85 (225)	7.27 (185)	•	•	•		•		•			
SUPCG060810F	10.85 (276)	8.85 (225)	7.27 (185)	•	•	•		•	•		•		
SUPCT060810F	10.85 (276)	8.85 (225)	7.27 (185)	•	•	•		•		•	•		
SUPCG060810HML	10.85 (276)	8.85 (225)	7.27 (185)	•	•	•	•	•	•			•	
SUPCT060810HML	10.85 (276)	8.85 (225)	7.27 (185)	•	•	•	•	•		•		•	
SUPCG060810HMLF	10.85 (276)	8.85 (225)	7.27 (185)	•	•	•	•	•	•		•	•	
SUPCT060810HMLF	10.85 (276)	8.85 (225)	7.27 (185)	•	•	•	•	•		•	•	•	
SUPCG060810HNL	10.85 (276)	8.85 (225)	7.27 (185)	•	•	•	•	•	•				•
SUPCT060810HNL	10.85 (276)	8.85 (225)	7.27 (185)	•	•	•	•	•		•			•
SUPCG060810HNLF	10.85 (276)	8.85 (225)	7.27 (185)	•	•	•	•	•	•		•		•
SUPCT060810HNLF	10.85 (276)	8.85 (225)	7.27 (185)	•	•	•	•	•		•	•		•
SUPCG060810HS	10.85 (276)	8.85 (225)	7.27 (185)	•	•	•	•	•	•				
SUPCT060810HS	10.85 (276)	8.85 (225)	7.27 (185)	•	•	•	•	•		•			
SUPCG060810HSF	10.85 (276)	8.85 (225)	7.27 (185)	•	•	•	•	•	•		•		
SUPCT060810HSF	10.85 (276)	8.85 (225)	7.27 (185)	•	•	•	•	•		•	•		

NOTE: Sizes reflect Exterior dimensions

Polycon Series Polycarbonate Enclosures

Part Number	Length Inch (mm)	Width Inch (mm)	Depth Inch (mm)	IP 66	IP 68	IP 69	Hinged Cover	Screw Cover	Opaque Cover	Clear Cover	Mounting Flange	Metal Locking Latch	Non-Metal Locking Latch
SUPCG061012	12.82 (326)	10.86 (276)	7.27 (185)	•	•	•		•	•				
SUPCT061012	12.82 (326)	10.86 (276)	7.27 (185)	•	•	•		•		•			
SUPCG061012F	12.82 (326)	10.86 (276)	7.27 (185)	•	•	•		•	•		•		
SUPCT061012F	12.82 (326)	10.86 (276)	7.27 (185)	•	•	•		•		•	•		
SUPCG061012HML	12.82 (326)	10.86 (276)	7.27 (185)	•	•	•	•	•	•			•	
SUPCT061012HML	12.82 (326)	10.86 (276)	7.27 (185)	•	•	•	•	•		•		•	
SUPCG061012HMLF	12.82 (326)	10.86 (276)	7.27 (185)	•	•	•	•	•	•		•	•	
SUPCT061012HMLF	12.82 (326)	10.86 (276)	7.27 (185)	•	•	•	•	•		•	•	•	
SUPCG061012HNL	12.82 (326)	10.86 (276)	7.27 (185)	•	•	•	•	•	•				•
SUPCT061012HNL	12.82 (326)	10.86 (276)	7.27 (185)	•	•	•	•	•		•			•
SUPCG061012HNLF	12.82 (326)	10.86 (276)	7.27 (185)	•	•	•	•	•	•		•		•
SUPCT061012HNLF	12.82 (326)	10.86 (276)	7.27 (185)	•	•	•	•	•		•	•		•
SUPCG061012HS	12.82 (326)	10.86 (276)	7.27 (185)	•	•	•	•	•	•				
SUPCT061012HS	12.82 (326)	10.86 (276)	7.27 (185)	•	•	•	•	•		•			
SUPCG061012HSF	12.82 (326)	10.86 (276)	7.27 (185)	•	•	•	•	•	•		•		
SUPCT061012HSF	12.82 (326)	10.86 (276)	7.27 (185)	•	•	•	•	•		•	•		
SUPCG101618	18.99 (482)	16.98 (431)	11.26 (286)	•	•	•		•	•				
SUPCT101618	18.99 (482)	16.98 (431)	11.26 (286)	•	•	•		•		•			
SUPCG101618F	18.99 (482)	16.98 (431)	11.26 (286)	•	•	•		•	•		•		
SUPCT101618F	18.99 (482)	16.98 (431)	11.26 (286)	•	•	•		•		•	•		
SUPCG101618HML	18.99 (482)	16.98 (431)	11.26 (286)	•	•	•	•	•	•			•	
SUPCT101618HML	18.99 (482)	16.98 (431)	11.26 (286)	•	•	•	•	•		•		•	
SUPCG101618HMLF	18.99 (482)	16.98 (431)	11.26 (286)	•	•	•	•	•	•		•	•	
SUPCT101618HMLF	18.99 (482)	16.98 (431)	11.26 (286)	•	•	•	•	•		•	•	•	
SUPCG101618HNL	18.99 (482)	16.98 (431)	11.26 (286)	•	•	•	•	•	•				•
SUPCT101618HNL	18.99 (482)	16.98 (431)	11.26 (286)	•	•	•	•	•		•			•
SUPCG101618HNLF	18.99 (482)	16.98 (431)	11.26 (286)	•	•	•	•	•	•		•		•
SUPCT101618HNLF	18.99 (482)	16.98 (431)	11.26 (286)	•	•	•	•	•		•	•		•
SUPCG101618HS	18.99 (482)	16.98 (431)	11.26 (286)	•	•	•	•	•	•				
SUPCT101618HS	18.99 (482)	16.98 (431)	11.26 (286)	•	•	•	•	•		•			
SUPCG101618HSF	18.99 (482)	16.98 (431)	11.26 (286)	•	•	•	•	•	•		•		
SUPCT101618HSF	18.99 (482)	16.98 (431)	11.26 (286)	•	•	•	•	•		•	•		

NOTE: Sizes reflect Exterior dimensions



Corner Elevator System

Industry exclusive corner elevator system uses a slotted shelf technology with bracket pieces that are easy to install, align, and keep level. Markings in the corners help you to install all elevator parts at the same height. This elevator system also allows for a back panel to be raised off the back of the enclosure.



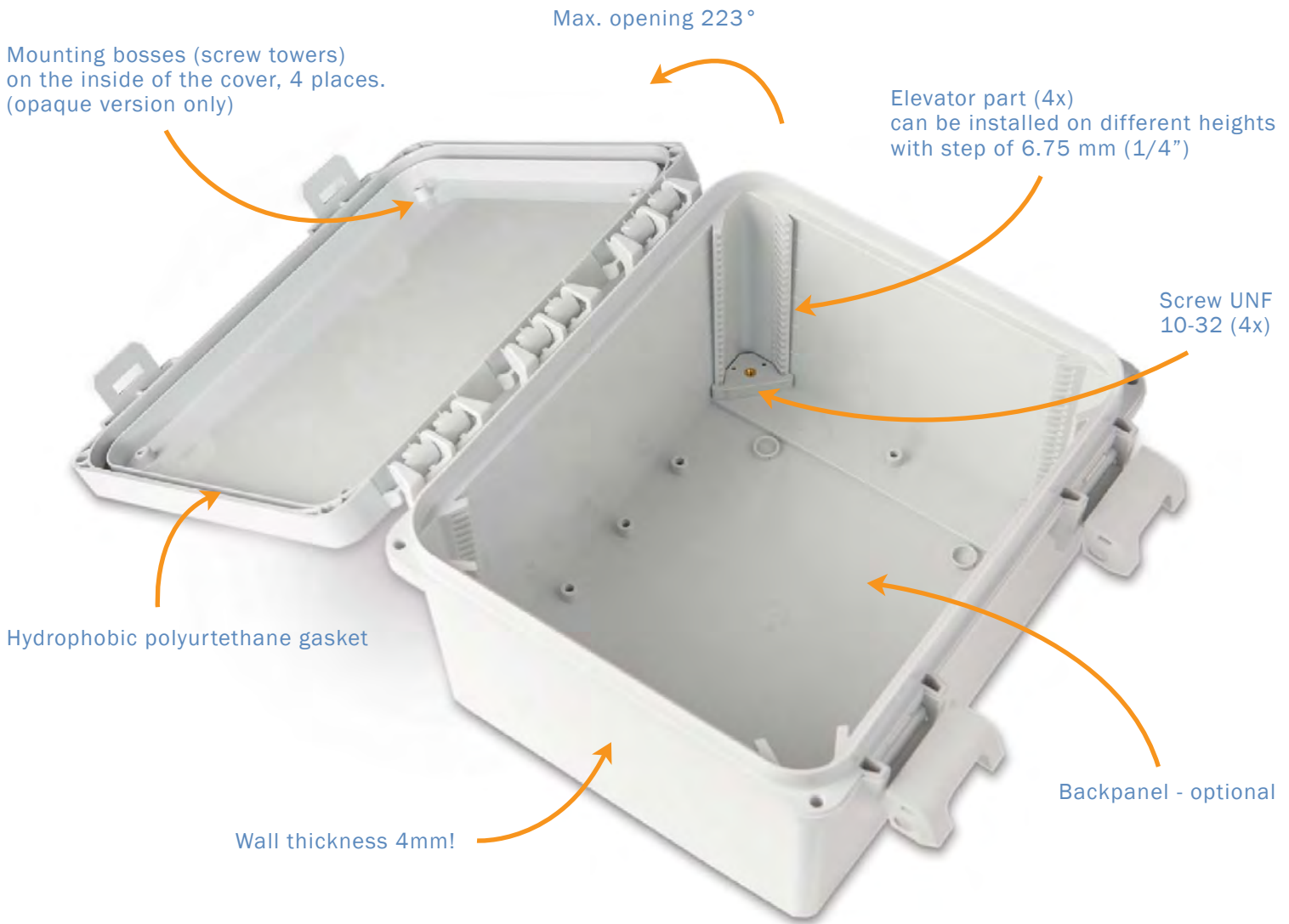

Latching Mechanisms

Sealcon's Polycon Series Polycarbonate Enclosures are offered in stainless steel metal locking latches and non-metallic locking latches.

