

M16/M23 STAINLESS STEEL CONNECTORS

FOR EXTREMELY ROUGH OR HYGIENIC USES

Mechanical Data	Materials and Technical Data
Housing	Stainless Steel 316L
Housing surface	Clear
Inserts	Thermoplastic Polyamide PA 6 (Nylon 6/6), PBT Fire protection class V-0
Contacts	Brass Alloy
Contact surface at point of contact	Nickel and gold plated (0.25 µm)
Minimum mating cycles	> 1000 (Sealcon to Sealcon connector)
Seals / O-Rings	FKM (Green), Optional EPDM (Green)
Temperature range	-40 °F - 257 °F (-40 °C - 125 °C)
Type of contacts signal M23	Crimp, solder, dip-solder (PCB)
Type of contacts power M23	Crimp
Type of contacts M16	Crimp, dip-solder (PCB)
Protection	IP 67 / IP 69K per EN 60529 (connected), NEMA 4x

Special applications require special solutions. When extremely rough or hazardous environments are a concern, 316L Stainless Steel options are available. Offered in the same pin-out configurations as the standard connectors, stainless steel housings will exceed your demands. Available in M16, and M23 sizes. EMI ready options! Other sizes are available by special order.



Additional Information			
Electrical data see standard product		Inserts and contacts see standard product	
M16 Connectors	page 19	M16 Connectors	pages 24 - 26
M23 Signal Connectors	page 37	M23 Signal Connectors	pages 44 - 48
M23 Power Connectors	page 50	M23 Power Connectors	page 56



*STAINLESS STEEL HOUSINGS DO NOT INCLUDE INSERTS AND CONTACTS. REFER TO APPLICABLE CONNECTOR SIZE AND TYPE SECTIONS FOR CONFIGURATION OPTIONS.



WE DO NOT RECOMMEND DISCONNECTING OR CONNECTING SEALCON CONNECTORS UNDER LOAD.

*ASSEMBLY INSTRUCTIONS CAN BE FOUND AT WWW.SEALCONUSA.COM OR BY CALLING US AT 1-800-456-9012

M16/M23 STAINLESS STEEL CONNECTORS

HOUSINGS

M16 Straight Connector, EMI, Female Thread

Cable-Ø

Part Number

3 - 6 mm (.12" - .24").....	S7.814.300.000
5 - 9 mm (.20" - .35").....	S7.814.400.000
8 - 11 mm (.31" - .43").....	S7.814.500.000

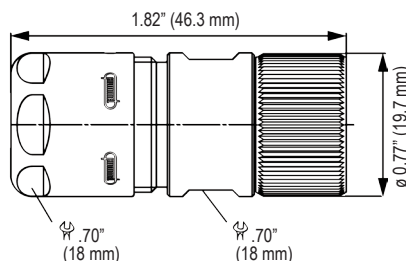

M16 Straight Connector, EMI, Male Thread

Cable-Ø

Part Number

3 - 6 mm (.12" - .24").....	S7.824.300.000
5 - 9 mm (.20" - .35").....	S7.824.400.000
8 - 11 mm (.31" - .43").....	S7.824.500.000

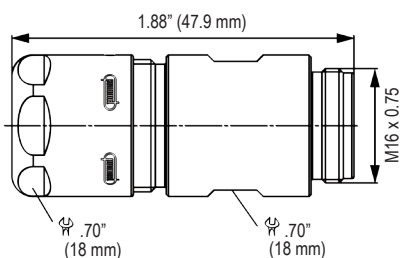

M16 Panel Connector, Male Thread, Flange

Type

Part Number

Front Mounting, Flange 20 x 20 mm

4 x Holes Ø 2.7 mm.....	S7.840.400.000
-------------------------	----------------

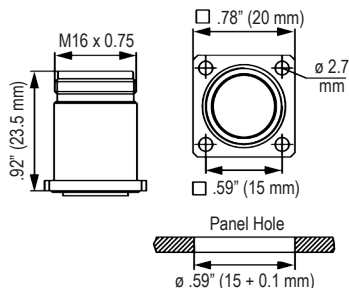

M23 Signal Straight Connector, EMI, Female Thread

Cable-Ø

Part Number

Part Number EMI

3 - 7 mm (.12 - .28").....	S7.140.300.000.....	S7.141.300.000
5 - 10 mm (.20 - .39").....	S7.140.400.000.....	S7.141.400.000
7 - 12 mm (.27 - .47").....	S7.140.500.000.....	S7.141.500.000
10 - 14 mm (.39 - .55")...	S7.140.600.000.....	S7.141.600.000

ASSEMBLY TOOL S7.010.900.127 IS REQUIRED

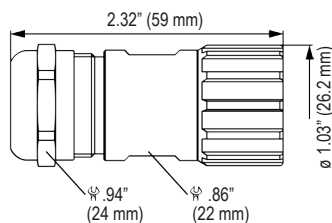

M23 Signal Straight Connector, EMI, Male Thread

Cable-Ø

Part Number

Part Number EMI

3 - 7 mm (.12 - .28")	S7.240.300.000.....	S7.241.300.000
5 - 10 mm (.20 - .39").....	S7.240.400.000.....	S7.241.400.000
7 - 12 mm (.27 - .47").....	S7.240.500.000.....	S7.241.500.000
10 - 14 mm (.39 - .55")...	S7.240.600.000.....	S7.241.600.000

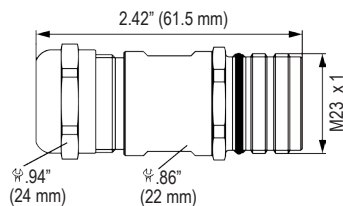

STAINLESS STEEL HOUSINGS DO NOT INCLUDE INSERTS AND CONTACTS. REFER TO APPLICABLE CONNECTOR SIZE AND TYPE SECTIONS FOR CONFIGURATION OPTIONS.